

443

Ball valve of stainless steel with threaded ends DN 15 - 50

06.02.2007

Operation

Ball valve 443 is a tightly closing on-off valve suitable for liquid and gas pipe systems. It is used for example in industrial pipe lines.

Nominal pressure PN 40 DN 15 - 50
Tightness class ISO 5208, EN 12266-1 RATE A
Operating temperature max +220°C/ min -40°C

The max pressure difference depends on the working temperature

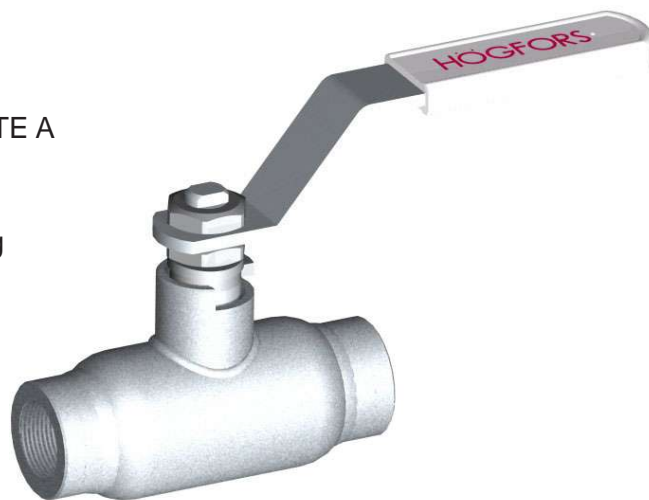
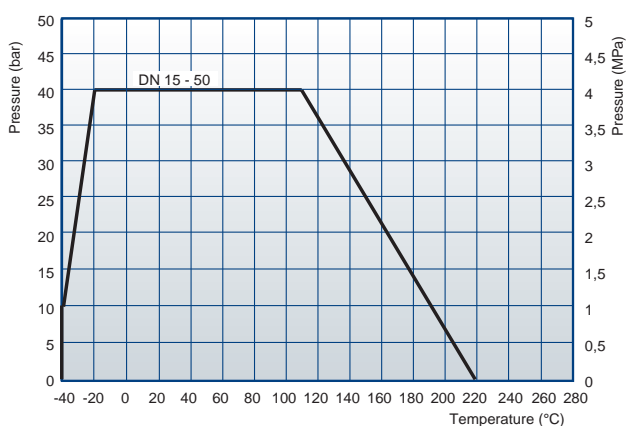

Construction

This welded ball valve with threaded ends and the body is made of stainless steel. Floating ball and blow-out proof stem are made of stainless steel. Ball sealing is of PTFE+C. Stem has tightable PTFE-rings.

Conform with the requirements of the Council Directive 97/23/EC on Pressure Equipement, marking:
 Class: Gas, group 1



Nominal dimensions: DN 15 - 50
Product codes: 443TS_ _ _ with handlever

Materials

Body: EN 10217-7 1.4404, DIN 17457 1.4404
Ball: EN 10217-7 1.4404, DIN 17457 1.4404
Stem: EN 10272 1.4404
Seal: PTFE+C
Stem seal: PTFE

443

Ball valve of stainless steel with threaded ends DN 15 - 50

06.02.2007

Dimensions

DN	PN	Kv ₁₀₀	d	R	L	H	h	l	Weight kg
15	40	8	10	G 1/2	85	73	30	110	0,4
20	40	13	15	G 3/4	100	73	30	110	0,5
25	40	25	20	G 1	110	95	36	140	0,9
32	40	41	24	G 1 1/4	130	98	36	140	1,1
40	40	65	31	G 1 1/2	140	122	47	180	2,1
50	40	100	39	G 2	170	128	47	180	2,9

